

**Transit Plugs**  
**H Series Heavy Duty – BSP & Metric Sizes 6° Taper**

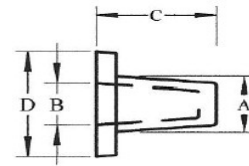

Series No.	To Fit Female Thread	A (mm)	B (mm)	C (mm)	D (mm)
H 1/16"	1/16" BSP	5.6	5.6	15.1	15.1
H 1/8"	1/8" BSP	7.9	7.1	17.5	18.3
H 1/4"	1/4" BSP	11.1	9.5	20.6	22.2
H 3/8"	3/8" BSP	14.3	12.7	22.2	25.4
H 1/2"	1/2" BSP	18.3	16.7		30.2
H 3/4"	3/4" BSP	23.0	21.4		35.7
H 1"	1" BSP	30.2	27.8		41.3
H 10		33.4	31.7		49.2
H 1-1/4"	1-1/4" BSP	39.7	38.1		54
H 1-1/2"	1-1/2" BSP	46.0	44.5		60.3
H 15		47.6	46		61.9
H 16		52.4	50.8		66.7
H 2"	2 " BSP	57.2	55.6		71.4

**Transit Plugs / Caps**  
**L Series Light Duty – BSP Sizes 3° Taper**

Note: Dual use as plug or cap

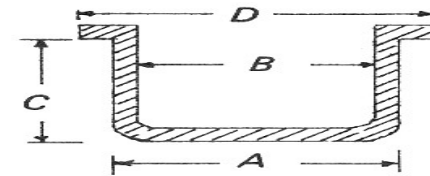

Series No.	To Fit Female Thread	A (mm)	Male Thread B	C (mm)	D (mm)
L1	1/8" BSP	8.7	9/32"	7.9	12.75
L2	1/4" BSP	12.0	1/8" BSP 3/8"	8.8	15.93
L3	3/8" BSP	15.1	1/4" BSP 17/32"	11.1	19.12
L4	1/2" BSP	19.0	3/8" BSP 21/32"	12.7	24.6
L5	5/8" BSP	20.6	1/2" BSP 25/32"	13.5	27.1
L6	3/4" BSP	23.9	5/8" BSP 7/8"	15.9	30.3

Minimum Order Quantity of Transit Plugs = 500 Pieces

**Transit Plugs**  
**S Series Short Light Duty – BSP Sizes**

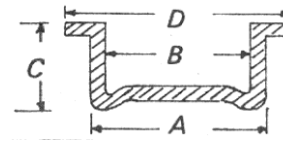

Note: JIC is the same size as UNF

Series No.	To Fit Female Thread	A (mm)	B (mm)	C (mm)	D (mm)
S1	1/8" BSP	8.7	6.7	4.8	12.7
S2	1/4" BSP	11.9	10.3	5.7	15.1
S3	3/8" BSP	15.1	14.3	7.1	19.0
S4	1/2" BSP	19.0	17.5	7.9	23.8
S5	5/8" BSP	20.6	19.8	8.7	27.0
S6	3/4" BSP	24.6	23.8	9.5	31.0
S8	1" BSP	30.2	28.6	10.3	36.5
S10	1-1/4" BSP / 1-5/8" JIC	38.9	36.5	11.9	46.0
S12	1-1/2" BSP / 1-7/8" JIC	44.5	42.9	14.3	52.4
S16	2" BSP	56.4	54.0	15.9	63.5

**Transit Plugs**  
**M Series Short Light Duty – Metric Sizes**

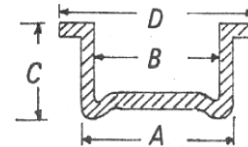

Note: JIC is the same size as UNF

Series No.	To Fit Female Thread	A (mm)	B (mm)	C (mm)	D (mm)
M13	13mm / 9/16 JIC	12.7	11.9	5.6	14.3
M18	18mm / 3/4" JIC	17.5	16.7	8.7	22.2
M22	22mm / 7/8" JIC	22.2	20.6	9.5	28.6
M25	25mm / 1-1/16" JIC	24.6	23.8		30.2
M28	28mm / 1-3/16" JIC	28.2	28.6		36.5
M31	31mm / 1-5/16" JIC	30.9	26.2	10.3	33.3
M62	62mm / 2-1/2" JIC	61.9	57.2	16.7	68.8

**Colours Available**

R	Red
Y	Yellow
B	Blue
W	White
Clear	Natural

Minimum Order Quantity of Transit Plugs = 500 Pieces

**Transit Plugs ( Earth Point )**  
**EP Series Push Fit Light Duty – Metric Sizes**

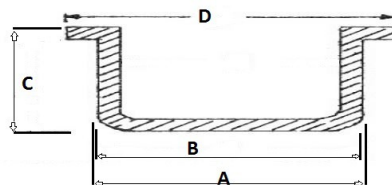

Series No.	To Fit Hole	A (mm)	B To fit size	C (mm)	D (mm)
EP1	-----			---	---
EP2	8.0 mm	11.5	7.0 to 8.5	7.8	11.5
EP3	-----			--	---
EP4	14.0 mm	19.0	13 to 14.5	10	18
EP5	17.0 mm	17.5	16 to 17.5	10	21

Red, White or Natural